



# KVN STEELS...

Excellence Quality Trust



GLOBAL REACH



IN-DEPTH RESEARCH



FOCUSSED APPROACH

**OUR**  
CONTACT:



+91 7977706520  
+91 8433627692



info@kvnsteels.com



www.kvnsteels.com

# BUSINESS VISIONS

"As One of the leading steel company in India, [Kvn steels \(metal suppliers\)](#) has always been our endeavor to continuously strengthen our domestic business and market position, further our ranking as a significant regional player and achieve progress across our operations, all of which, we believe, should contribute to a growth-led financial performance and result in creation of enhanced value for our customers."

*We help customers develop their energy resources; bringing world class capability and delivering it locally. We promote commercial arrangements that are aligned to our customers' needs, allowing us to deliver more value to the customer while increasing the returns from our most precious asset – our people.*



[Kvn steels \(metal suppliers\)](#) is a leading Supplier of all Ferrous & Non-Ferrous Metals.

As a pioneer [Kvn steels \(metal suppliers\)](#) is at the forefront of technology and research.

We are constantly innovating, listening to the rapidly changing market and giving the consumer the best value for his money.

[Kvn steels \(metal suppliers\)](#) is a force to reckon with in the field of exporting premium quality. Fittings, & Flanges in Carbon Steel, Alloy Steel, Stainless Steel, Duplex Stainless Steel and Low Temperature Services. We are based in Mumbai (India), the company has scaled incredible heights in business owing to its innovative products. The company's productivity and clients base is always on an upward swing.

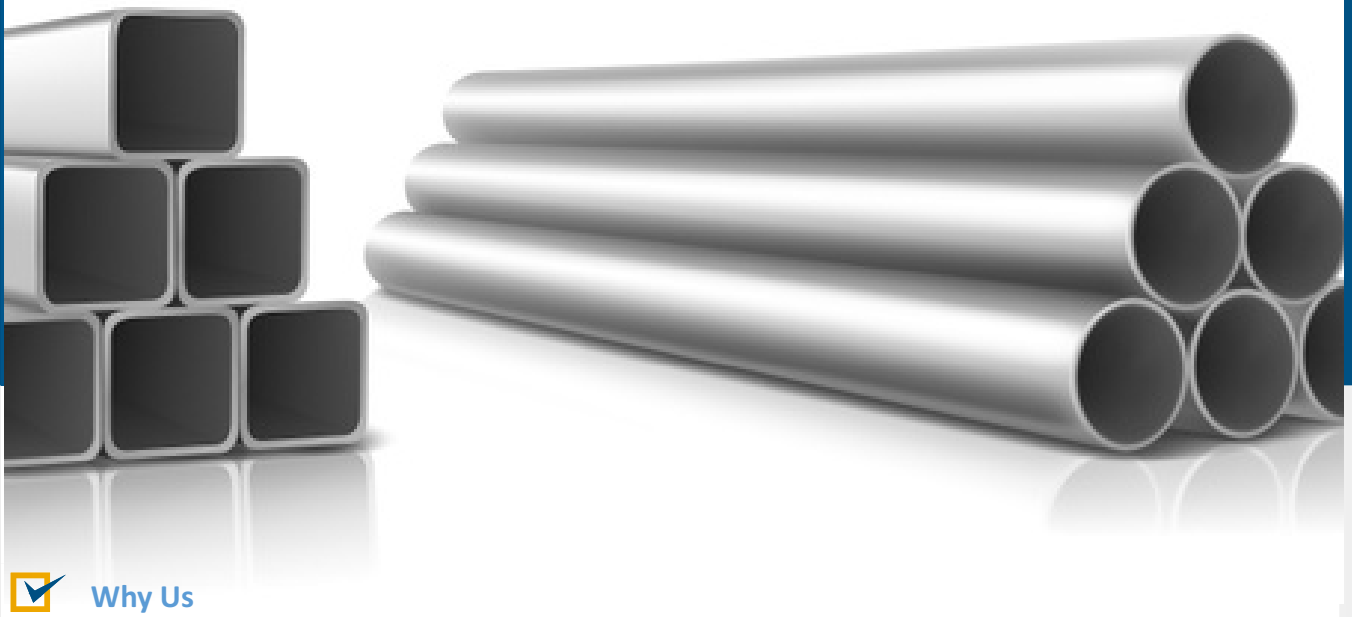

### Why Us

We are a renowned name in this domain engaged in providing various types of SS,

CS & AS Products. Owing to our excellent product quality and transparent dealings, we have gained immense clients' appreciation.



#### We are trusted by our customers for the following reasons:

- Superior quality products
- Timely delivery schedule
- Cost-effective rates
- Timely delivery of products
- Easy payment modes
- Good Financial Position & TQM
- Customized solution
- Customized packaging



# Certificate of Registration



*This is to Certify That The Quality Management System of*

**KVN STEELS...**

SWAPNA CHS LTD, R-5, PLOT NO. 107, CHARKOP SECTOR-01,  
KANDIVALI - WEST, MUMBAI- 400067, MAHARASHTRA, INDIA.

*has been assessed and found to conform to the requirements of*

**ISO 9001:2015**

*for the following scope :*

EXPORTER, IMPORTER, SUPPLIER & STOCKIST OF VARIOUS TYPES  
OF FERROUS & NON FERROUS METALS

Certificate No	20DQGJ01	
Initial Registration Date	: 18/01/2020	Issuance Date : 18/01/2020
Date of Expiry	: 17/01/2023	
1st Surve. Due	: 18/12/2020	2nd Surve. Due : 18/12/2021

**DIRECTOR**

**ROHS Certification Pvt. Ltd.**

408, Madhuban Building, 55, Nehru Place, New Delhi - 110 019, India

Phone : +91.11.41525522 | e-mail : [info@rohscertification.co.in](mailto:info@rohscertification.co.in) | website : [www.rohscertification.co.in](http://www.rohscertification.co.in)

The Registration is not a Product Quality Certificate, subject to successful completion of surveillance audits, visit for verification on [www.rohscertification.co.in](http://www.rohscertification.co.in)  
Certificate is the Property of ROHS and return when demanded



**eiāci**  
مركز الإمارات العالمي للاعتماد  
Emirates International Accreditation Centre  
035-CB-QMS





## Certificate of Registration

### PRESSURE EQUIPMENT DIRECTIVE

Certificate No. 15439

This is to certify that the Management System of

**KVN STEELS...**

Plot No. 107/5, Swapna Housing, Sector-1, Charkop, Kandivali West,  
Mumbai - 400067, Maharashtra, India.

has been found to conform to

## European Directive 2014/68/EU

This Certificate is valid for the below scope of services and as mentioned in Annexure

**Manufacturer of Pipes & Tubes (Seamless & Welded), Fittings & Flanges in  
Stainless Steel, Carbon Steel, Alloy Steel, Duplex Steel, Super Duplex  
Steel, Titanium, Nicked Alloys and Cupro-Nickel.**

Date of Registration

30/01/2021

Re-certification Date

29/01/2024



Date of Expiry

29/01/2022

Signed on behalf of AQSR

*Bharat*



The certificate is valid for three years subject to satisfactory annual assessment. To check certificate authenticity, please visit [www.aqsrusa.com](http://www.aqsrusa.com)

Europe Office : 105, Smith Street, Coventry CV65EH, Warwickshire, United Kingdom, Web : [www.aqsrusa.com](http://www.aqsrusa.com)

Accreditation by United States Accreditation Council (USAC) LLC, Miami, Florida, USA, Web - [www.usacamerica.org](http://www.usacamerica.org)

# PIPES & TUBES

We are Manufacturers, Exporters and Supplier of wide range Pipes & Tubes in Mumbai, India.

These Pipes & Tubes are manufactured using high quality raw materials which are controlled and tested by our experts. All the Pipes & Tubes are produced as per the National & International Industrial Standards. We have Pipes & Tubes in various types and grades such as Stainless Steel, Carbon Steel, Duplex Steel, Super Duplex Steel, Alloy Steel, Nickel Alloy, Titanium Alloy, Aluminium Alloy & Cupro-Nickel Alloy.

Stainless Steel Pipes & Tubes :: Hastelloy Pipes & Tubes :: Carbon Steel Pipes & Tubes :: Inconel / Incoloy Pipes & Tubes

Alloy 20 Pipes & Tubes :: Copper Nickel Pipes & Tubes :: Monel Pipes & Tubes :: Alloy Steel Pipes & Tubes

Aluminum Pipes & Tubes :: Nickel Pipes & Tubes :: Titanium Pipes & Tubes :: Alloy Steel Welded Pipe

## Stainless Steel Pipes Dimension (Schedule, Wall Thickness & Weight) Part - 1

Designation of Diameter		O/D	Nominal Wall Thickness																	
		DIA	SCH.5S		SCH.5		SCH 10S		SCH.10		SCH.20S		SCH.30		SCH.40S		SCH.40		SCH 60	
(A)	(B)	Meter MM	Wall Thk	Weight Kg/Mtr	Wall Thk	Weight Kg/Mtr	Wall Thk	Weight Kg/Mtr	Wall Thk	Weight Kg/Mtr	Wall Thk	Weight Kg/Mtr	Wall Thk	Weight Kg/Mtr	Wall Thk	Weight Kg/Mtr	Wall Thk	Weight Kg/Mtr	Wall Thk	Weight Kg/Mtr
6	1/8	10.3	1	0.23			1.2	0.27			1.5	0.33			1.73	0.37				
8	1/4	13.7	1.2	0.37			1.65	0.49			2	0.58			2.24	0.64				
10	3/8	17.2	1.2	0.47			1.65	0.63			2	0.74			2.31	0.87				
15	1/2	21.3	1.65	0.01	1.65	0.81	2.11	1.02	2.11	1.02	2.5	1.15			2.77	1.29				
20	3/4	26.7	1.65	1.03	1.65	1.03	2.11	1.3	2.11	1.3	2.5	1.49			2.87	1.71				
25	1	33.4	1.65	1.31	1.65	1.31	2.77	2.13	2.77	2.13	3	2.24			3.38	2.54				
32	1 1/4	24.2	1.65	1.67	1.65	1.67	2.77	2.73	2.77	2.73	3	2.9			3.56	3.44				
40	1 1/2	48.3	1.65	1.93	1.65	1.93	2.77	3.16	2.77	3.16	3	3.35			3.68	4.11				
50	2	60.3	1.65	1.93	1.65	2.42	2.77	3.99	2.77	3.99	3.5	4.9			3.91	5.52				
65	2 1/2	73	2.11	3.75	2.11	3.75	3.05	5.34	3.05	5.34	3.5	6			5.16	8.77				
80	3	88.9	2.11	4.59	2.11	4.59	3.05	6.56	3.05	6.56	4	8.37			5.49	11.47				
90	3 1/2	101.6	2.11	5.25	2.11	5.25	3.05	7.53	3.05	7.53	4	9.62			5.74	13.78				
100	4	114.3	2.11	5.93	2.11	5.93	3.05	8.5	3.05	8.5	4.5	12.18			6.02	6.32				
125	5	141.3	2.77	9.61	2.77	9.61	3.4	11.74	3.43	11.74	5	16.8			6.55	22.10				
150	6	168.3	2.77	11.47	2.77	11.47	3.4	14.04	3.43	14.04	5.5	22.08			7.11	28.69				
200	8	219.1	2.77	15	2.77	15	3.76	20.77	3.76	20.27	6.35	33.82	7.04	37.38	8.18	43.2			10.81	53.9
250	10	273.1	3.4	22.95	3.4	22.95	4.19	28.2	4.19	28.2	6.35	42.41	7.8	51.81	9.27	61.22			12.2	82.8
300	12	323.9	3.96	31.72	4.19	33.6	4.57	36.54	4.57	36.54	6.35	50.48	8.38	66.2	9.53	75.01	10.31	80.94	14.27	110.62
350	14	355.6	3.96	34.86			4.78	41.99	6.35	55.53	7.92	68.95	9.53	82.58	9.53	82.58	11.13	96	15.06	128.42
400	16	406.4	4.19	42.2			4.78	48.07	6.35	63.61	7.92	79.03	9.53	94.7	9.53	94.7	12.7	125.2	16.66	162.59
450	18	457.2	4.19	47.46			4.78	54.15	6.35	71.69	7.92	89.1	11.13	124.32	9.53	106.83	14.27	158.27	19.05	209
500	2C	508	4.78	60.23			5.54	69.7	6.35	79.76	9.53	118.93	12.7	157.51	9.53	118.9	15.06	185.89	2062	251.65
550	22	558.8	4.78	65.95			5.54	76.75	6.35	87.84	9.53	131.07	12.7	173.66	9.53	131.07	15.88	216.04	22.23	298.55
600	24	609.6	5.54	83.8			6.35	95.92	6.35	95.92	9.53	143.2	14.27	212.72	9.53	143.2	17.45	258.74	24.59	360.21
650	26	660.4							7.92	129.4	12.7	205.97			9.53	155.32				
700	28	711.2							7.92	139.47	12.7	222.13	15.88	276.48	9.53	167.44				
750	3C	762	6.35	120.15			7.92	149.55	7.92	149.55	12.7	238.28	15.88	296.68	9.53	179.56				
800	32	812.8							7.92	159.62	12.7	254.44	15.88	316.88	9.53	191.69	17.48	348.11		
850	34	863.6							7.92	169.64	12.7	270.5	15.88	336.96	9.53	203.74	17.48	370.22		
900	36	914.4							7.92	179.77	12.7	286.75	15.88	357.28	9.53	215.93	19.05	427.09		

## PIPES & TUBES

We are Manufacturers, Exporters and Supplier of wide range Pipes & Tubes in Mumbai, India. These Pipes & Tubes are manufactured using high quality raw materials which are controlled and tested by our experts. All the Pipes & Tubes are produced as per the National & International Industrial Standards.

We have Pipes & Tubes in various types and grades such as Stainless Steel, Carbon Steel, Duplex Steel, Super Duplex Steel, Alloy Steel, Nickel Alloy, Titanium Alloy, Aluminium Alloy & Cupro-Nickel Alloy.

Stainless Steel Pipes & Tubes :: Hastelloy Pipes & Tubes :: Carbon Steel Pipes & Tubes :: Inconel / Incoloy Pipes & Tubes

Alloy 20 Pipes & Tubes :: Copper Nickel Pipes & Tubes :: Monel Pipes & Tubes :: Alloy Steel Pipes & Tubes

Aluminum Pipes & Tubes :: Nickel Pipes & Tubes :: Titanium Pipes & Tubes :: Alloy Steel Welded Pipe

# Stainless Steel Pipes Dimension (Schedule, Wall Thickness & Weight) Part - 2

Designation of Diameter		O/D	Nominal Wall Thickness													
		DIA	SCH 80 S		SCH 80		SCH 100		SCH 120		SCH. 140		SCH.160		SCH.XXS	
(A)	(B)	Meter MM	Wall Thk	Weight Kg/Mtr	Wall Thk	Weight Kg/Mtr	Wall Thk	Weight Kg/Mtr	Wall Thk	Weight Kg/Mtr	Wall Thk	Weight Kg/Mtr	Wall Thk	Weight Kg/Mtr	Wall Thk	Weight Kg/Mtr
6	1/8	10.3	2.41	0.47												
8	1/4	13.7	3.02	0.82												
10	3/8	17.2	3.2	1.12												
15	1/2	21.3	3.73	1.64									4.75	1.97	7.47	2.59
20	3/4	26.7	3.91	2.93									5.54	2.93	7.82	3.69
25	1	33.4	4.55	3.29									6.35	4.3	9.09	5.53
32	1 1/4	24.2	4.85	4.53									6.35	5.69	9.7	7.88
40	1 1/2	48.3	5.08	5.49									7.14	7.35	10.16	9.69
50	2	60.3	5.54	7.6									8.71	11.26	11.07	13.65
65	2 1/2	73	7.01	11.59									9.53	15.15	14.02	20.72
80	3	88.9	7.62	15.51									11.13	21.67	15.24	28.11
90	3 1/2	101.6	8.08	18.92											16.15	34.56
100	4	114.3	8.56	22.66					11.13	28.75			13.49	34.05	17.12	41.66
125	5	141.3	9.53	31.44					12.7	40.9			15.88	49.87	19.05	58.31
150	6	168.3	10.97	43.21					14.27	55.03			18.24	68.53	21.95	79.1
200	8	219.1	12.7	65.63			15.06	76.93	18.24	91.73	20.62	102.47	23.01	112.97	22.23	108
250	10	273.1	12.7	82.8	15.06	97.27	18.24	116.38	21.41	134.9	25.4	157.51	28.58	174.95	25.4	155.5
300	12	323.9	12.7	98.95	17.45	133.88	21.41	162.14	25.4	189.82	28.58	211.31	33.32	242.4	25.4	189.82
350	14	355.6	12.7	109.04	19.05	160.54	23.8	197.74	27.76	227.88	31.75	257.47	35.71	286.04		
400	16	406.4	12.7	125.2	21.41	206.4	26.19	249.34	30.94	290.88	36.53	338.32	40.46	370.74		
450	18	457.2	12.7	141.35	23.8	258.29	29.36	314.54	34.93	369.34	39.67	414.74	45.24	466.67		
500	2C	508	12.7	157.51	26.19	315.97	32.54	387.41	38.1	448.3	44.45	515.94	49.99	573.31		
550	22	558.8	12.7	173.66	28.57	379.7	34.92	457.83	41.27	535.17	47.62	609.3	53.97	682.57		
600	24	609.6	12.7	189.82	30.94	448.3	38.89	555.76	46.02	649.44	52.37	730.72	59.51	819.7		
650	26	660.4	12.7	205.97			(24.66D-t) t									
700	28	711.2			12.7	222.13	1000									
750	3C	762			1270	238.28	Wt/pam + formula									
800	32	812.8			12.7	254.44	Weight Stainless Steel Pipe									
850	34	863.6			12.7	270.5										
900	36	914.4			12.7	286.75	OD (mm) - W.T. (mm) XW.T. (mm) X 0.02466 = Kg. per mtr.									

# PIPES & TUBES

Kvn steels (metal suppliers) are Manufacturers, Exporters and Supplier of wide range Pipes & Tubes in Mumbai, India. These Pipes & Tubes are manufactured using high quality raw materials which are controlled and tested by our experts. All the Pipes & Tubes are produced as per the National & International Industrial Standards.

We have Pipes & Tubes in various types and grades such as Stainless Steel, Carbon Steel, Duplex Steel, Super Duplex Steel, Alloy Steel, Nickel Alloy, Titanium Alloy, Aluminium Alloy & Cupro-Nickel Alloy.

## Dimension & Weight - Standard Tubing Sizes

Dimension		10SWg	12SWg	14SWg	16SWg	18SWg	20SWg	22SWg
Size inches	OD in mm	3.25mm Wt Kg/M	2.64mm Wt Kg/M	2.03mm Wt Kg/M	1.62mm Wt Kg/M	1.21mm Wt Kg/M	0.91mm Wt Kg/M	0.71mm Wt Kg/M
3/8	9.52	0.549	0.447	0.405	0.341	0.268	0.193	0.165
1/2	12.7	0.768	0.654	0.542	0.451	0.350	0.264	0.213
3/4	19.05	1.285	1.068	0.864	0.710	0.544	0.407	0.320
1	25.4	1.801	1.482	1.187	0.969	0.738	0.549	0.432
1 1/4	31.75	2.801	1.482	1.187	0.969	0.738	0.549	0.432
1 1/2	38.1	2.834	2.309	1.832	1.487	1.126	0.820	0.654
1 3/4	45.00	3.408	2.722	2.191	1.775	1.341	0.834	
2	50.8	3.868	3.136	2.478	2.006	1.541	1.119	0.877
2	50.8	3.868	3.136	2.478	2.006	1.541	1-119	0.877
2 1/2	63.5	4.901	3.963	3.123	2.524	1.858	-	-
3	76.2	5.934	4.790	3.453	2.789	2.237	-	-
3 1/2	88.9	6.964	5.617	4.413	3.560	2.616	-	-
4	101.6	8.000	6.444	5.059	4.078	2.995	-	-
4 1/2	114.3	8.900	7.272	5.620	4.501	3.374	-	-
5	127-0	9.917	8.099	6.255	5.008	3.753	-	-
6	152.4	11.953	9.753	7.527	6.023	4.474	-	-

**Cold Rolled Stainless Steel Strips** are welded into tubes in the state of the art tube mills under fully automated precision process.

The manufacturing of pipes begins with sitting of strips of required width based on the diameter of the tubes to be formed.

Stainless still slitted strips are passed through a series of rollers and tubes / pipes are formed automatically on different stands with rolls and welded on fully automated process of TIG welding without the addition of filler metal. The welding head line is polished continuously with the help of automatic bead polishing machine to produce a perfect bore. The tubes are then passed through a series of sizing rolls to ensure ovality and tolerances. Tubes / pipes are then cut to length, Cold-drawn, Solution Annealed, Straightened, Pickled, Passivated and Polished before other Destructive and Non-destructive Testing & Dispatch.

### Size

6MM OD - 152.4MM OD

### Thickness

0.71 MM - 3.25 MM THK

### Specification

ASTM, ASME, DIN, NFA, JIS etc.

### Grades

**Austenitic Grade:** TP-304, 304L, 304H, 316, 316L, 316H, 316Ti, 317, 321, 347, 310, 904L,

**Ferritic / Duplex Grades:** UNS S32750, S32760, S31803, S31500, 32205



# PIPES & TUBES

Kvn steels (metal suppliers) are Manufacturers, Exporters and Supplier of wide range Pipes & Tubes in Mumbai, India. These Pipes & Tubes are manufactured using high quality raw materials which are controlled and tested by our experts. All the Pipes & Tubes are produced as per the National & International Industrial Standards.

We have Pipes & Tubes in various types and grades such as Stainless Steel, Carbon Steel, Duplex Steel, Super Duplex Steel, Alloy Steel, Nickel Alloy, Titanium Alloy, Aluminium Alloy & Cupro-Nickel Alloy.

## ASTM Specification & Tolerance For Tubing & Piping

Specification	Allowable Outside Diameter Variation in mm			Allowable Wall Thickness Variation		Exact Length Tolerance in mm		Testing
	Nominal Diameter	Over	Under	%Over	%Under	Over	Under	
ASTM-A213 Seamless Boiler Superheater and Heat Exchanger Tubes	Under 25.4	.1016	.1016	+20	-0	3.175	0	Flattening Test
	25.4-38.1 incl	.1524	.1524	+22	-0	3.175	0	Tension Test
	38.1-50.8 excl	.2032	.2032	+22	-0	3.176	0	Flare Test
	50.8-63.5 excl	.254	.254	+2	-0	4.46	0	Hardness Test
	63.5-76.2 excl	.3048	.3048	+22	-0	4.76	0	100% Hydrostatic test
	76.2-101.6 incl	.381	.381	+22	-0	4.76	0	Refer to ASTM A-450
ASTM-A249 Welded Boiler Superheater, Heat Exchanger And Condenser Tubes	Under 25.4	.1016	.1016	+10	-10	3.175	0	Tension Test
	25.4-38.1 incl	.1524	.1524	+10	-10	3.175	0	Flattening Test
	38.1-50.8 Excl	.2032	.2032	+10	-10	3.175	0	Flange Test
	50.0-63.5 excl	.254	.254	+10	-10	4.762	0	Reverse Bend Test
	63.5-76.2 excl	.3848	.3848	+10	-10	4.762	0	Hardness Test
	76.2-101.6 incl	.381	.381	+10	-10	4.762	0	100% Hydrostatic Test Refer to ASTM A-450
				Minimum Wall tubes +18% 0 available On request				



# FLANGES

We are Manufacturers, Exporters and Supplier of wide range Flanges in Mumbai, India. These Plates, Sheets & Coils are manufactured using high quality raw materials which are controlled and tested by our experts. All the Flanges are produced as per the National & International Industrial Standards. We has Flanges in various types and grades such as Stainless Steel, Carbon Steel, Duplex Steel, Super Duplex Steel, Alloy Steel, Nickel Alloy, Titanium Alloy & Cupro-Nickel Alloy.

Stainless Steel Flanges :: Hastelloy Flanges :: Carbon Steel Flanges :: Inconel / Incoloy Flanges

Alloy 20 Flanges :: Copper Nickel Flanges :: Monel Flanges :: Alloy Steel Flanges

Aluminum Flanges :: Nickel Flanges :: Titanium Flanges :: Alloy Steel Welded Flanges

## Size & Dimensions of Forged Flanges

150 lbs

150 lbs	Common sizes to 150 lbs flanges							WELDING-NECK 150 lbs		SLIP-ON 150 lbs		UVP-JOINT 150 lbs		
Nominal Bore	Diam. D	E Thick	Diam. F	Diam. B	DRILLING			Diam d1	(1) H Height	(1) H Height	Diam. A	(1) H Height	Diam. A	A Radius
					Nbre	Holes Diam	DiamC							
1/2	89.0	11.0	34.9	30.0	04	16	60.03	21.03	47.06	16.0	22.04	16.00	22.09	3.01
3/4	98.5	12.7	42.9	38.0	04	16	69.09	26.07	52.04	16.0	27.07	16.00	28.02	3.01
1	108.5	14.3	50.8	49.0	04	16	79.04	33.04	55.06	17.5	34.05	17.05	35.01	3.01
1 1/4	117.5	15.9	63.5	59.0	04	16	88.09	42.02	57.02	20.5	43.02	20.05	43.07	4.07
1 1/2	127.0	17.5	73.0	65.0	04	16	98.04	48.03	61.09	22.0	49.05	22.00	50.00	6.03
2	152.5	19.0	92.1	78.0	04	19	120.06	60.03	63.05	25.5	62.00	25.05	62.05	7.09
2 1/2	178.0	22.2	104.8	90.5	04	19	139.07	73.00	70.00	28.5	74.07	28.05	75.05	7.05
3	190.5	23.8	127.0	108.0	04	19	152.04	88.09	70.00	30.0	90.07	30.00	91.05	9.05
3 1/2	216.0	23.8	139.7	122.0	08	19	177.08	101.06	71.05	32.0	103.04	32.00	104.02	9.05
4	228.5	23.8	157.2	135.0	08	19	19.05	114.03	76.02	33.5	116.01	33.05	116.09	11.01
5	254.0	23.8	185.7	163.5	08	23	215.09	141.03	76.02	33.5	116.01	33.05	116.09	11.01
6	279.5	25.4	215.9	192.0	08	23	241.03	168.03	88.09	39.5	170.07	39.05	171.05	12.07
8	343.0	28.6	269.9	246.0	08	23	298.05	219.01	102.00	44.5	221.05	44.05	222.03	12.07
10	406.5	30.2	323.9	305.0	12	25	362.00	273.00	102.00	49.0	276.04	49.00	277.04	12.07
12	482.2	31.8	381.0	365.0	12	25	431.08	323.09	114.03	55.5	327.02	55.05	328.02	12.07
14	533.5	35.0	412.8	400.0	12	29	476.03	355.06	127.00	57.0	359.02	79.04	360.02	12.07
16	567.0	36.5	469.9	457.0	16	29	539.08	406.04	127.00	63.5	410.05	87.03	411.02	J2.07
18	635.0	39.7	533.4	505.0	16	32	577.09	457.02	139.07	68.5	461.05	96.08	462.03	12.07
20	698.5	42.9	584.2	559.0	20	32	635.00	508.00	144.05	73.0	513.01	103.02	514.04	12.07
24	813.0	47.6	692.2	663.5	20	35	749.03	609.06	152.04	82.5	616.00	111.01	616.00	12.07

# PIPES & TUBES

Kvn steels (metal suppliers) are Manufacturers, Exporters and Supplier of wide range Pipes & Tubes in Mumbai, India. These Pipes & Tubes are manufactured using high quality raw materials which are controlled and tested by our experts. All the Pipes & Tubes are produced as per the National & International Industrial Standards.

We have Pipes & Tubes in various types and grades such as Stainless Steel, Carbon Steel, Duplex Steel, Super Duplex Steel, Alloy Steel, Nickel Alloy, Titanium Alloy, Aluminium Alloy & Cupro-Nickel Alloy.

## ASTM Specification & Tolerance For Tubing & Piping

ASTM-A269 Seamless & Welded Tubing for General Service	Untp12.7	.13	.13	+15	-15	3.2	0	Flare Test (Seamless Only)
	12.7-38.1 excl	.13	.13	+10	-10	3.2	0	Flange Test (Welded Only)
	38.1-88.9 excl	.25	.25	+10	-10	4.8	0	Hardness Test
	88.9-139.7 excl	.38	.38	+10	-10	4.8	0	Reverse Flattening Test
	139.7-203.2 excl	.76	.76	+10	-10	4.8	0	(Welded only) 100% Hydrostatic Test Refer to ASTM-A269
ASTM-A270 Seamless & Welded Sanitary Tubing	25.4	.05	.20	+10.0	-10.0	3.2	0	Reverse flattening Test
	38.1	.05	.20	+10.0	-10.0	3.2	0	100% Hydrostatic Test
	50.8	.05	.28	+10.0	-10.0	3.2	0	External' polish on all tubes
	60.5	.05	.28	+10.0	-10.0	3.2	0	Refer to ASTM A-270
	76.2	.08	.30	+10.0	-10.0	3.2	0	
	101.6	.08	.38	+10.0	-10.0	3.2	0	
ASTM-A312 Seemless & Welded pipe	3.175-38.1 incl	.4	.79	Minimum Wall 12.5% under nominal wall Specified		6.4	0	Tension Test
	38.1-101.6 incl	.79	.79			6.4	0	Flattening Test
	101.6-203.2 imcl	1.59	.79			6.4	0	100% Hydrostatic Test
						(Normally Random Lengths ordered		Refer to ASTM A-530
ASTM A-358 Welded pipe	219.08- 750mm or 0.01 inch	+0.5%		-0.3		6.0		Refer to ASTM A-530

# FLANGES

## Size & Dimensions of Forged Flanges Others

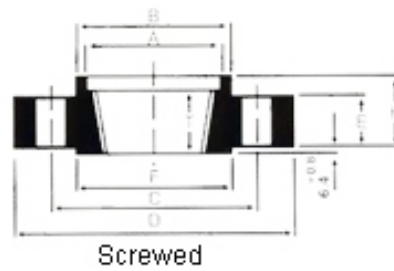
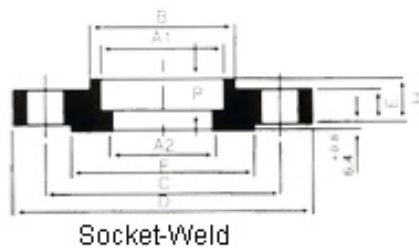

600 lbs							1500 lbs						
Nominal bore	Socket-Welding			Screwd			Socket-Welding			Screwd			Nominal bore in inches
	H (2)	A1	P	H (2)	A	T	H (2)	A1	P	H (2)	A	T	
1/2	22.2	22.4	9.5	22.2	23.6	15.9	31.8	22.4	9.5	31.8	23.6	22.2	1/2
3/4	28.4	27.7	11.1	25.4	29	15.9	34.9	27.7	11.1	34.9	29	25.4	3/4
1	27.0	34.5	12.7	27.0	35.8	17.5	41.3	34.5	12.7	41.3	35.8	28.6	1
1 1/4	28.6	43.2	14.3	28.6	44.5	20.6	41.3	43.2	14.3	41.3	44.5	30.2	1 1/4
1 1/2	31.8	49.5	15.9	31.8	50.6	22.2	44.5	49.5	15.9	44.5	50.6	31.8	1 1/2
2	36.5	62.0	17.5	36.5	63.5	28.6	57.2	62.0	17.5	57.2	63.5	38.1	2
2 1/2	41.3	74.7	19.1	41.3	76.2	31.8	63.5	74.7	19.1	63.5	76.2	47.6	2 1/2
3	46.0	90.7	20.7	46.0	92.2	34.7				73.0	92.2	50.8	3
3 1/2				49.2	104.9	39.7				90.5	117.6	57.2	3 1/2
4				54.0	117.6	41.3				104.8	114.5	63.5	4

2) 150 lbs 300 lbs flanges, raised face of 1/2" included in H & E  
600 up to 2500 flanges, R. F. of 1/4" is not included in H & E

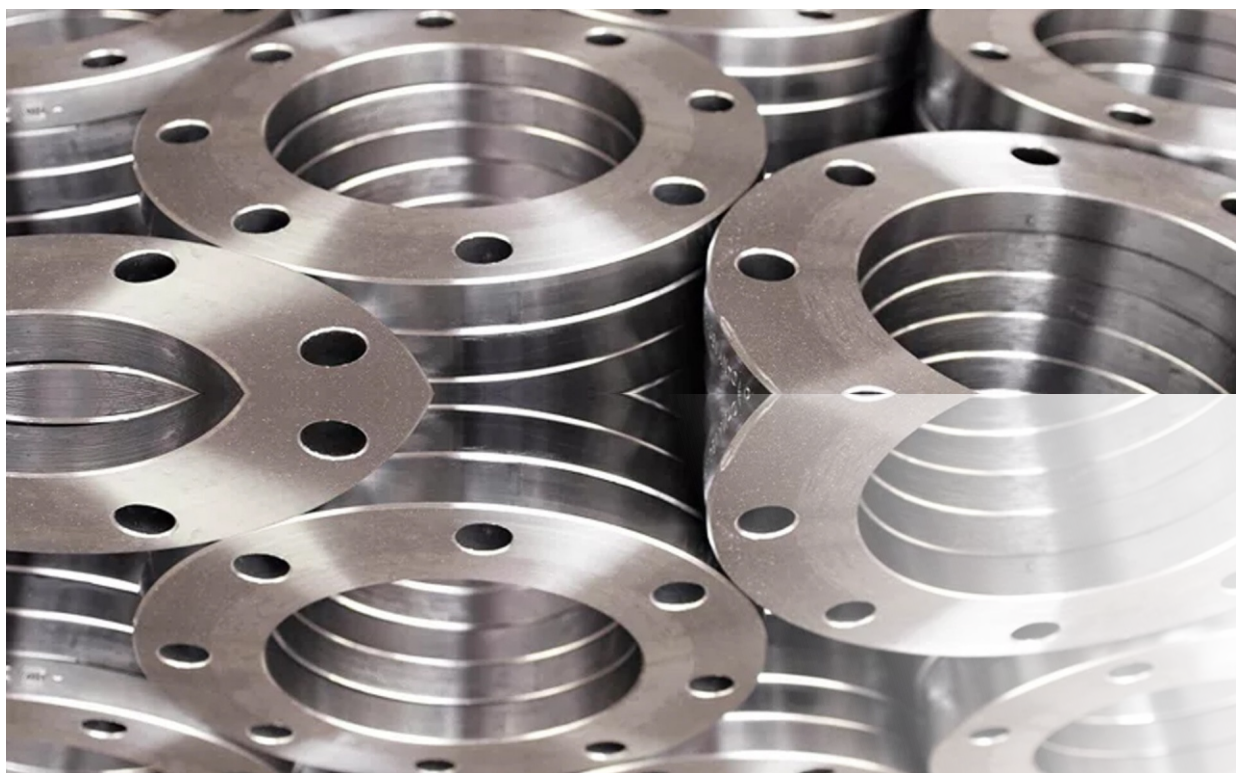



# FLANGES

## Size & Dimensions of Forged Flanges

2500 lbs

2500 lbs	Common sizes to 300 lbs flanges							WELDING-NECK 2500 lbs		SLIP-ON 2500 lbs		LAP-JOINT 2500 lbs		
Nominal Bore	Diam. D	E Thick	Diam. F	Diam. B	DRILLING			Diam d1	(1) H Height	(1) H Height	Diam. A	(1) H Height	Diam. A	A Radius
					Nbre	Holes Diam	Diam C							
1/2	133.5	30.2	34.9	43.0	4	22.2	89.0	21.3	73.0	39.7	22.4	39.7	22.9	3.1
3/4	140.0	31.8	42.9	51.0	4	22.2	95.0	26.7	79.4	42.9	27.7	42.9	28.2	3.1
1	159.0	34.9	50.8	57.0	4	25.4	108.0	33.4	88.9	47.6	34.5	47.6	35.1	3.1
1 1/4	184.0	38.1	63.5	73.0	4	29.0	130.0	42.2	95.3	52.3	43.2	52.4	43.7	4.7
1 1/2	203.0	44.5	73.0	79.5	4	32.0	146.0	48.3	111.1	60.3	49.5	60.3	50.0	6.3
2	235.0	50.8	92.1	95.0	8	29.0	171.5	60.3	127.0	69.9	62.0	69.9	62.5	7.9

## Size & Dimensions of Forged Flanges

Others

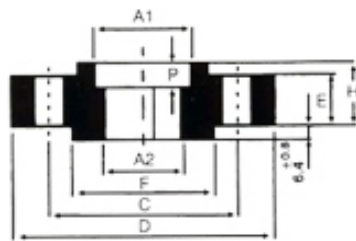

Socket-Weld

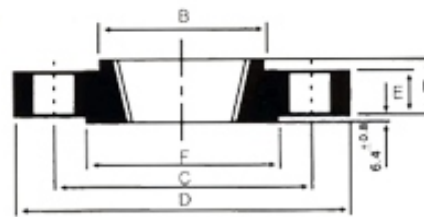

Screwed

150 lbs						300 lbs							
Nominal bore	Socket-Welding			Screwed		Socket-Welding			Screwed				Nominal bore in inches
	(2) H Height	Diam. A1	P Depth	(R) H Height	(1) Kg Weight	(2) H	Diam A1	Depth P	(2) H Height	Diam A	T Height	Kg Weight	
1/2	00.16	22.4	09.05	00.16	0.500	22	22.4	9.5	22	23.6	15.9	0.700	1/2
3/4	00.16	27.7	11.01	16.00	0.700	25.5	27.7	11.1	25.5	29	15.9	1.130	3/4
1	17.05	34.5	12.07	12.05	0.900	27	34.5	12.7	27	35.8	17.8	1.360	1
1 1/4	20.05	43.2	14.03	20.05	1.200	27	43.2	14.3	27	44.5	20.6	2.050	1 1/4
1 1/2	00.22	49.5	15.30	22.00	1.400	30	49.5	15.9	30	50.6	22.2	2.950	1 1/2
2	25.05	62.0	17.05	25.05	2.300	33.5	62	17.5	33.5	63.5	28.6	3.200	2
2 1/4	28.05	74.7	19.01	28.05	3.600	38	74.7	19.1	38	76.2	31.8	4.530	2 1/2
3	00.30	90.7	20.07	00.30	4.500	43	90.7	20.7	43	92.2	31.8	6.350	3
3 1/2	00.32	103.4	22.02	00.32	5.400	44.5	103.4	22.2	44.5	104.9	36.5	7.300	3 1/4
4	33.05	116.1	23.08	33.05	5.900				47.5	117.6	38.5	10.870	4

# FLANGES

## Size & Dimensions of Forged Flanges

300 lbs

300 lbs	Common sizes to 300 lbs flanges							WELDING-NECK 300 lbs		SLIP-ON 300 lbs		LAP-JOINT 300 lbs		
Nominal Bore	Diam. D	E Thick	Diam. F	Diam. B	DRILLING			Diam d1	(1) H Height	(1) H Height	Diam. A	(1) H Height	Diam. A	A Radius
					Nbre	Holes Diam	Diam C							
1/2	95.0	14.5	34.9	38	04	16.0	67.0	21.3	52.5	22.0	22.2	22.4	22.9	3.1
3/4	117.5	16.0	42.9	48	04	19.0	83.0	26.7	57.0	25.5	27.7	25.4	28.2	3.1
1	124.0	14.5	50.8	54	04	19.0	89.0	33.4	62.0	27.0	34.5	27.0	35.1	3.1
1 1/4	133.5	19.0	63.5	63	04	16.0	98.5	42.2	65.0	27.0	43.5	27.0	43.7	4.7
1 1/2	156.0	20.5	73.0	70	04	22.2	114.5	48.3	68.5	30.0	49.5	30.2	50.0	6.3
2	165.0	22.0	92.1	84	08	19.0	127.0	60.3	70.0	33.5	62.0	33.3	62.5	7.9
2 1/2	190.5	25.5	104.8	100	08	22.2	149.0	73.0	76.0	38.0	74.7	38.1	75.4	7.9
3	209.5	28.5	127.0	117	08	22.2	168.5	88.9	79.5	43.0	90.7	42.9	91.5	9.5
3 1/2	229.0	30.5	139.7	133	08	22.2	184.0	101.6	81.0	44.5	103.4	44.5	104.2	9.5
4	254.0	31.5	157.2	146	08	22.2	200.0	114.3	85.5	47.5	116.1	47.6	116.9	11.1
5	279.0	35.0	185.7	178	08	22.2	235.0	141.3	98.5	50.5	143.5	50.8	144.5	11.1
6	317.5	36.5	215.9	206	12	22.2	270.0	168.3	98.5	52.5	170.7	52.4	171.5	12.7
8	381.0	41.5	269.9	260	12	25.4	330.0	219.1	111.0	62.0	221.5	61.9	222.3	12.7
10	444.5	47.5	323.9	321	16	29.0	387.5	273.0	117.5	66.5	276.4	95.3	277.4	12.7
12	520.5	51.0	381.9	375	16	32.0	451.0	323.9	130.0	73.0	327.2	101.6	328.2	12.7
14	584.0	54.0	412.8	425	20	32.0	514.5	355.6	143.0	79.0	359.2	111.1	360.2	12.7
16	647.5	57.0	469.9	483	20	35.0	571.5	406.4	146.0	82.5	410.5	120.7	411.2	12.7

## Size & Dimensions of Forged Flanges

600 lbs

600 lbs	Common sizes to 600 lbs flanges							WELDING-NECK 600 lbs		SLIP-ON 600 lbs		UVP-JOINT 600 lbs		
Nominal Bore	Diam. D	E Thick	Diam. F	Diam. B	DRILLING			Diam d1	(1) H Height	(1) H Height	Diam. A	(1) H Height	Diam. A	A Radius
					Nbre	Holes Diam	DiamC							
1/2	95.0	14.3	34.9	38	04	16	67.0	21.3	52.4	22.2	22.4	22.2	22.9	3.1
3/4	117.5	15.9	42.9	48	04	19	83.0	26.7	57.2	25.4	27.7	25.4	28.2	3.1
1	124.0	17.5	50.8	54	04	19	89.0	33.4	61.9	27.0	34.5	27.0	35.1	3.1
1 1/4	133.5	20.6	63.5	63	04	19	98.5	42.2	66.7	28.6	43.2	28.6	43.7	4.7
1 1/2	190.5	28.6	104.8	100	08	23	114.5	48.3	69.9	31.8	49.5	31.8	50.0	6.3
2	165.0	25.4	92.1	084	08	19	127.0	60.3	73.0	36.5	62.0	36.5	62.5	7.9
2 1/2	190.5	28.5	104.8	100	08	23	149.0	73.0	79.4	41.3	74.7	41.3	75.4	7.9
3	209.5	31.8	127.0	117	08	23	168.5	88.9	82.5	46.0	90.7	46.0	91.0	9.5
3 1/2	229.0	34.9	139.7	133	08	25	184.0	101.6	85.7	49.0	103.4	46.0	91.5	9.5
4	273.0	38.1	157.2	152	08	25	216.0	114.3	101.6	54.0	116.1	54.0	116.9	11.1
5	330.0	44.5	185.7	189	08	29	267.0	141.3	144.3	60.3	116.1	60.3	144.5	11.1
6	355.5	47.6	215.5	222	12	29	292.0	168.3	117.5	66.7	170.7	66.7	171.5	12.7



# FITTINGS

## BUTTWELD FITTINGS –

Kvn steels (metal suppliers) is a leading Buttwelded Pipe Fitting Manufacturer Supplier and Dealer in India. Nitech Stainless Inc manufacturer's pipe fitting and buttwelded pipe fitting in all grades with high quality of material to manufacture the most durable and long lasting buttwelded pipe fittings. Nitech Stainless Inc also is one of the well-known supplier of buttwelded pipe fittings.

We have Buttweld Fittings in various types and grades such as Stainless Steel, Carbon Steel, Duplex Steel, Super Duplex Steel, Alloy Steel, Nickel Alloy, Titanium Alloy & Cupro-Nickel Alloy.

Stainless Steel Buttwelded Fitting :: Hastelloy Buttwelded Fitting :: Carbon Steel Buttwelded Fitting :: Inconel / Incoloy Buttwelded Fitting

Alloy Buttwelded Fitting :: Copper Nickel Buttwelded Fitting :: Monel Buttwelded Fitting :: Alloy Steel Buttwelded Fitting

Aluminum Buttwelded Fitting :: Nickel Buttwelded Fitting :: Titanium Buttwelded Fitting :: Alloy Steel Welded Buttwelded Fitting

Nominal Pipe Size	All Fittings			90 Deg. and 45 Deg. Elbows and Tees	Reducers and Lap. Joint Stub Ends	Caps	180 Deg. Returns			Lap. Joint Ends			
	Outside (1) Diameter at Bevel	Inside (2) Diameter at End	Wall (2) Thickness				Centre all Dimension 0	Back to Face Ends K	Alignment of Ends U	outside Daimeter of Lap G	Thick ness of Lap	Fillet radius of Lap R	Outside Diameter Barrel
1/2" to 2 1/2"	± 1	± 8	Not Less than 87.5% of Nominal	± 2	± 2	± 4	± 7	± 7	± 1	± 0-1	Not Less than nominal pipe wall thickness	+ 0-1	Refer Table Below
3" to 3 1/2"	± 1	± 1.6		± 2	± 2	± 4	± 7	± 7	± 1	± 0-1		+ 0-1	
4"	+ 2-1	± 1.6		± 2	± 2	± 4	+ 7	± 7	± 1	± 0-1		+ 0-2	
5" to 6"	+ 3-1	± 1.6		± 2	± 2	± 7	± 7	± 1	± 1	± 0-1		+ 0-2	
8"	± 2	± 1.6		± 2	± 2	± 7	± 7	± 7	± 1	± 0-1		+ 0-2	
10" I	+ 4-3	± 3.2		± 2	± 2	± 7	± 10	± 7	± 2	± 0-2		+ 0-2	
12" to 18"	+ 4-3	± 3.2		± 3	± 3	± 7	± 10	± 7	± 2	± 0-2		+ 0-2	
20" to 24"	+ 4-3	± 4.8		± 3	± 3	± 7	± 10	± 7	± 2	± 0-2		+ 0-2	
26" to 30"	+ 7-5	± 4.8		± 3	± 3	± 10	-	-	-	-		-	
32" to 48"	+ 7-5	± 4.8		± 5	± 5	± 10	-	-	-	-		-	



# FLANGES

## Size & Dimensions of Forged Flanges

600 lbs

600 lbs	Common sizes to 600 lbs flanges							WELDING-NECK 600 lbs		SLIP-ON 600 lbs		UVP-JOINT 600 lbs		
Nominal Bore	Diam. D	E Thick	Diam. F	Diam. B	DRILLING			Diam d1	(1) H Height	(1) H Height	Diam. A	(1) H Height	Diam. A	A Radius
					Nbre	Holes Diam	DiamC							
1/2	95.0	14.3	34.9	38	04	16	67.0	21.3	52.4	22.2	22.4	22.2	22.9	3.1
3/4	117.5	15.9	42.9	48	04	19	83.0	26.7	57.2	25.4	27.7	25.4	28.2	3.1
1	124.0	17.5	50.8	54	04	19	89.0	33.4	61.9	27.0	34.5	27.0	35.1	3.1
1 1/4	133.5	20.6	63.5	63	04	19	98.5	42.2	66.7	28.6	43.2	28.6	43.7	4.7
1 1/2	190.5	28.6	104.8	100	08	23	114.5	48.3	69.9	31.8	49.5	31.8	50.0	6.3
2	165.0	25.4	92.1	084	08	19	127.0	60.3	73.0	36.5	62.0	36.5	62.5	7.9
2 1/2	190.5	28.5	104.8	100	08	23	149.0	73.0	79.4	41.3	74.7	41.3	75.4	7.9
3	209.5	31.8	127.0	117	08	23	168.5	88.9	82.5	46.0	90.7	46.0	91.0	9.5
3 1/2	229.0	34.9	139.7	133	08	25	184.0	101.6	85.7	49.0	103.4	46.0	91.5	9.5
4	273.0	38.1	157.2	152	08	25	216.0	114.3	101.6	54.0	116.1	54.0	116.9	11.1
5	330.0	44.5	185.7	189	08	29	267.0	141.3	144.3	60.3	116.1	60.3	144.5	11.1
6	355.5	47.6	215.5	222	12	29	292.0	168.3	117.5	66.7	170.7	66.7	171.5	12.7
8	419.0	55.6	269.9	273	12	32	349.0	219.1	133.4	76.2	221.5	76.2	222.3	12.7
10	508.0	63.5	323.9	343	16	35	432.0	273.0	152.4	85.7	276.5	111.1	277.4	12.7
12	559.0	66.7	381.0	400	20	35	489.0	323.9	155.6	92.1	327.5	117.5	323.8	12.7
14	603.0	69.5	412.8	432	20	38	527.0	355.6	165.1	93.7	359.2	127.0	360.2	12.7
16	686.0	76.2	469.9	495	20	42	603.5	406.4	177.8	106.4	410.5	139.7	411.2	12.7
18	743.0	82.3	533.4	546	20	45	654.0	457.2	184.2	177.5	461.5	152.4	462.3	12.7
20	813.0	88.9	584.2	610	24	45	724.0	508.0	190.5	127.5	513.1	165.1	514.3	12.7
24	940.0	101.6	692.2	718	24	51	838.0	609.6	203.2	139.7	616.0	184.2	616.0	12.7

## Size & Dimensions of Forged Flanges

1500 lbs

1500 lbs	Common sizes to 300 lbs flanges							WELDING-NECK 1500 lbs		SLIP-ON 1500 lbs		LAP-JOINT 1500 lbs		
Nominal Bore	Diam. D	E Thick	Diam. F	Diam. B	DRILLING			Diam d1	(1) H Height	(1) H Height	Diam. A	(1) H Height	Diam. A	A Radius
					Nbre	Holes Diam	Diam C							
1/2	121.0	22.2	34.9	38.0	4	22.2	82.5	21.3	60.3	31.8	22.4	31.8	22.9	3.1
3/4	130.0	25.4	42.9	44.5	4	22.2	89.0	26.7	69.9	34.9	27.7	34.9	28.2	3.1
1	149.0	28.6	50.8	25.5	4	25.4	101.5	33.4	73.0	41.0	34.5	41.3	35.1	3.1
1 1/4	159.0	28.6	63.5	63.5	4	25.4	111.0	42.2	73.0	41.0	43.2	41.3	43.7	4.7
1 1/2	178.0	31.8	73.0	70.0	4	29.0	124.0	48.3	82.5	44.5	49.5	44.5	50.0	6.3
2	216.0	38.1	92.1	105.0	8	25.4	165.0	60.3	101.6	57.2	62.0	57.2	62.5	7.9
2 1/2	244.5	41.3	104.8	124.0	8	29.0	190.5	73.0	104.8	63.5	74.7	63.5	75.4	7.9
3	266.5	47.6	127.0	133.5	8	32.0	203.0	88.9	117.5	73.0	90.7	73.0	91.5	9.5
4	311.0	54.0	157.2	162.0	8	35.0	241.5	114.3	123.8	90.5	116.1	90.5	116.9	11.1
5	374.5	73.0	185.7	197.0	8	42.0	292.0	141.3	155.6	104.8	143.8	104.8	144.5	11.1
6	395.0	82.5	215.9	229.0	12	38.0	317.5	168.3	171.5	119.1	170.7	119.1	171.5	12.7

# FLANGES

Tolerance As Per B 16.5

The tolerances tabulated below, apply to all ANSI Flanges, APF large Diameter flanges, and the flanged ends of Welding Necks, Certain other tolerances apply to Orifice Flanges and those are as covered by American Gas Association recommendations.

## Thread, Slip-on, Lap Joint and Blind Flanges

Inside Diameter	Threaded	Within Limits of boring gauge
	10" and smaller	+ 0.76 - 0
	12" and larger	+ 0.152 - 0
Outside Diameter	24" or less over 24"	± 0.0625
		± 0.125
Diameter of Counterbore	Same as for Inside Diameter	
Diameter of contact Face	1.58mm Raised Face 150# & 300#	± 0.76
	6.35mm Raised Face above 300# Tongue & Groove or Male & Female	± 0.50
Outside Dia. of Hub	5" and Smaller	+ 2.28 - 0.76
	6" and larger	+ 4.06 - 0.76
Drilling	Bolt circle	± 1.52
	Bolt Hole spacing	± 0.76
Eccentricity Bolt circle & Facing (with respect to bore)	2 1/2" and smaller	± 0.76
	3" and larger	± 1.52
Thickness	18" and Smaller	+ 3.04 - 0
	20" and larger	+ 4.82 - 0

Except where indicated, the tolerances are those established by ANSI B 16.5 and the variations are maximum. In actual practice manufacturing and inspection procedures control dimensions so closely that variations are normally much less than those listed as permitted

## Welding Neck Flanges

Inside Diameter	10" and smaller	0.76
	12" to 18"	1.52
	20" and larger	+ 3.04 - 1.52
Outside Diameter	24" or less	0.0625
	over 24"	0.125
Diameter of contact Face	1.58mm Raised Face 150# & 300#	0.76
	6.35 mm Raised Face above 300# Tongue & Groove or Male & Female	+ 0.50
Diameter of Hub at point of Welding	5" and Smaller	+ 2.28 - 0.76
	6" and larger	+ 4.06 - 0.76
Drilling	Bolt circle	1.52
	Bolt Hole spacing	0.76
Eccentricity Bolt circle & Facing (with respect to bore)	2 1/2" and smaller	0.76
	3" and larger	1.52
Length thru. Hub	4" and smaller	1.52
	5" to 10"	+ 1.52 - 3.04
	12" and larger	+ 3.04 - 4.57
Thickness	18" and smaller	+ 3.04 - 0
	20" and larger	+ 4.82 - 0

# ROUND BARS

Kvn steels (metal suppliers) are Manufacturers, Exporters and Supplier of wide range Round Bars in mumbai, India. These Round Bars & Rods are manufactured using high quality raw materials which are controlled and tested by our experts. All the Round Bars are produced as per the National & International Industrial Standards.

We have Round Bars in various types and grades such as Stainless Steel, Carbon Steel, Duplex Steel, Super Duplex Steel, Alloy Steel, Nickel Alloy, Titanium Alloy, Aluminium Alloy & Cupro-Nickel Alloy.

Stainless Steel Round Bars :: Hastelloy Buttwelded Round Bars :: Carbon Steel Round Bars :: Inconel / Incoloy Round Bars

Alloy Buttwelded Round Bars :: Copper Nickel Round Bars :: Monel Round Bars :: Alloy Steel Round Bars

Aluminum Round Bars :: Nickel Alloy Round Bars :: Titanium Round Bars :: Super Duplex Round Bars





# SHEETS & PLATES

Kvn steels (metal suppliers) are Manufacturers, Exporters and Supplier of wide range Sheets & Plates in Mumbai, India. These Plates, Sheets & Coils are manufactured using high quality raw materials which are controlled and tested by our experts. All the Plates, Sheets & Coils are produced as per the National & International Industrial Standards.

We have Plates, Sheets & Coils in various types and grades such as Stainless Steel, Carbon Steel, Duplex Steel, Super Duplex Steel, Alloy Steel, Nickel Alloy, Titanium Alloy, Aluminium Alloy & Cupro-Nickel Alloy.

Stainless Steel Sheets & Plates :: Hastelloy Buttwelded Sheets & Plates :: Carbon Steel Sheets & Plates :: Inconel / Incoloy Sheets & Plates

Alloy Buttwelded Sheets & Plates :: Copper Nickel Sheets & Plates :: Monel Sheets & Plates :: Alloy Steel Sheets & Plates

Aluminum Sheets & Plates :: Nickel Sheets & Plates :: Titanium Sheets & Plates :: Super Duplex Sheets & Plates

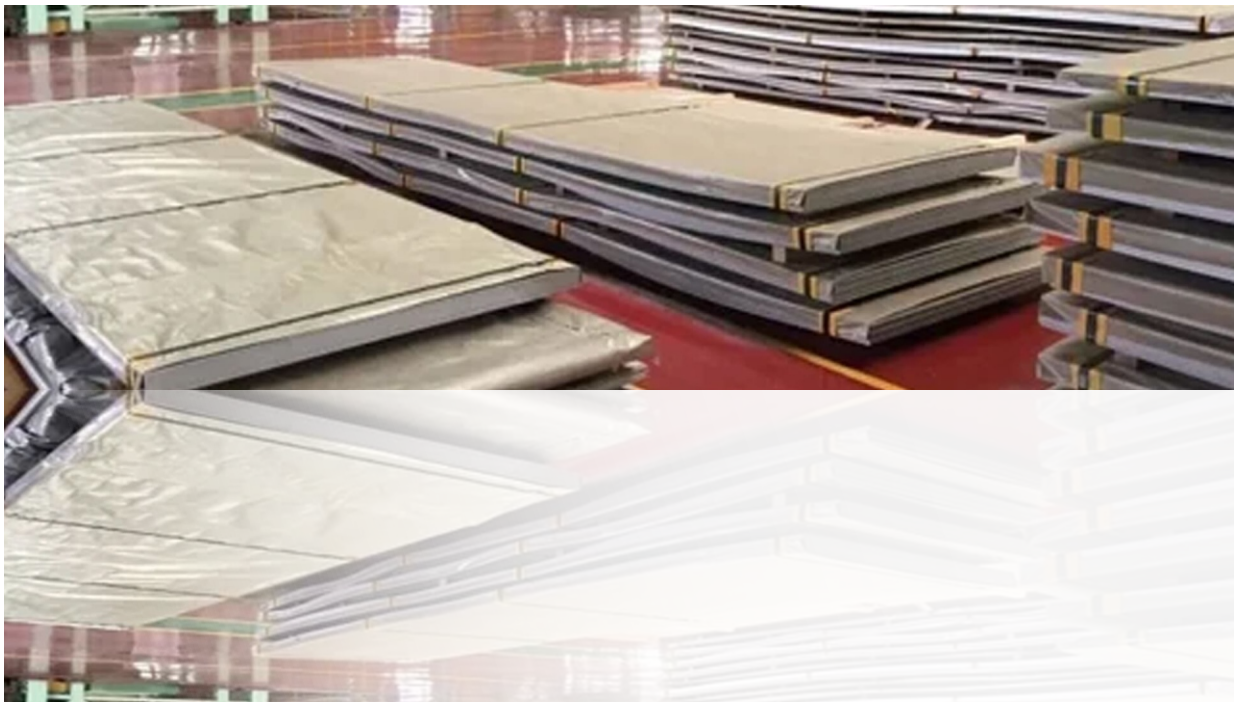





**KVN STEELS...**

Excellence Quality Trust

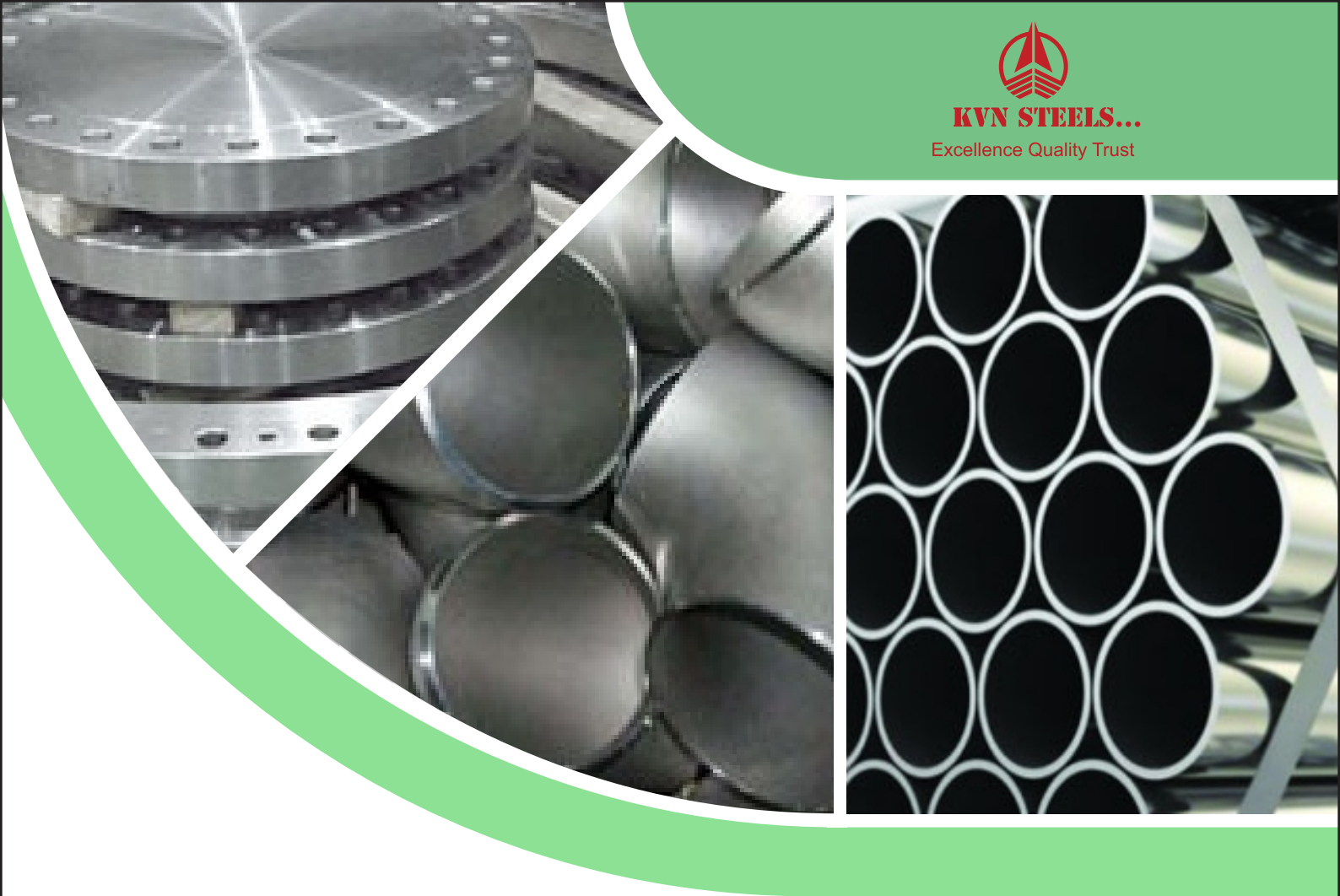

## **KVN STEELS (METAL SUPPLIERS)**

**Head Office:**

107/5, Sapna Housing Society, Sector -1,  
Charkop Industrial Estate,  
Charkop Rd, Kandivali, Charkop,  
Kandivali West,  
Mumbai, Maharashtra 400067

**Website:** [www.kvnsteels.com](http://www.kvnsteels.com)

**Email:** [info@kvnsteels.com](mailto:info@kvnsteels.com)

**Mobile:** +91 7977706520  
+91 8433627692